

Service Update

Subject: Improvements and Changes to Platen Seal

To: All Factory Authorized Service (FAS) Agents

Market: ACI

Date: 20th Oct 2020

Change To Platen Heater Plate To Add Additional Protection To The Cowl Seal

As part of our continuous improvement process, Garland have made a change to the way the platen cowl seal fits between the plant and the cowl. Garland feel this will improve the reliability and longevity of cowl seal on the (ME/MG). It will further protect the seal which was changed to a new material (Viton) in August 2019.

This change involves creating a lip on the platen, this lip raises up to cover most of the cowl seal and thus gives better mechanical protection of the seal

The images below show an example of the new design and the previous design. The design change was introduced onto production grill (ME/MG) in November 2019.

Previous design (up to October 2019)



Current design (from November 2019)



You may notice, when initially viewed it appears that the seal is missing on the new design when compared against the previous design. This shows the enhanced level of protection the new design

affords the cowl seal.

This change does NOT mean any change in part numbers, all existing seals and platen heaters are fully interchangeable between the previous and current design.

Dependent on the stock situation, if you place an order for a platen heater plate, you may or may not get one of the new designs. But as noted, none of the parts have changed except the addition of a lip on the platen heater.

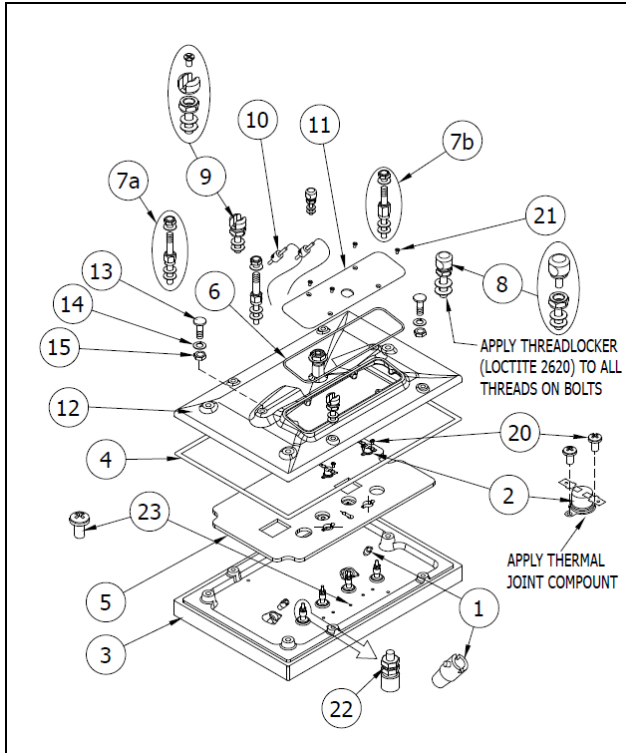

Item#	Photo	Part#	Description	Qty	Critical or Recommended
1		1859402	Platen Bayonet Adapter	2	
2	Photo	4531977	Thermostat SPST (open on rise 500F, close 420F)	2	C
3		4600191	Platen Heater 17.5" x 11.5" (must replace seal item # 4)	1	
4	Photo	4604267	Seal, Cowl to Platen	1	R
5	Photo	4600146	Platen Insulation	1	
6	Photo	4601963	Seal, Cowl to Lid (FKM O-Ring, As 568A-169)	1	
7a		CK4600585	Std Shoulder Bolt Assembly, Pearl	2	
7b	Photo	CK4600586	Short Shoulder Bolt Assembly, Pearl	1	
8	Photo	CK4600590	U-Bar Rear Holder Assembly	2	R
9	Photo	CK4600591	U-Bar Front Holder Assembly	2	R
10	Photo	4600100	Platen Thermocouple	2	C
11		4602855 up to s/n 19041001xxxxx	Service Hatch Cover W/WeldNut Holes	1	
11		4602712 from s/n 19051001xxxxx	Service Hatch Cover W/WeldNut Holes	1	
12		4600718	Cowl Asm, Pearl WG (World Grill)	1	
13		4600646	Sensor Target	2	C
14		F746	Lock Washer	2	
15		F747	Nut	2	

Item#	Photo	Part#	Description	Qty	Critical or Recommended
16		CK4600725 up to s/n 19041001xxxxx	Platen Harness TC Conduit GM Pkg - (Thermocouples & harness included)	1	
16		CK4603291 from s/n 19051001xxxxx	Platen Harness TC Conduit GM Pkg - (Thermocouples & harness included)		
17		4600652	O-Ring, ASS68A - 137	1	
18		4600653	Conduit Fitting Locknut, 1.5"	1	
19		4600606	Seal Conduit Fitting	1	
20		F162	Screw-6-32 X 1/4" Phillips Pan S/S	4	
21		F717 up to s/n 19041001xxxxx	#8-32X.312 U/Cut FHMS PH SS	6	
21		4603166 from s/n 19051001xxxxx	#8-32X.312 U/Cut FHMS PH SS	6	
22		F715	#10-32 Hex Keys Nut SS (for the element)	4	
23		F783	#8-32X3/16 Truss M/S SS (ground)	1	
24	Photo	CK4604091	Complete Assembled Platen - Cowl Assembly with Conduit - WG	1	
25		CK4602048	Complete Assembled Platen - Cowl Assembly - WG	1	R

Please scan the QR code below if you would like to view the "How To" video on changing the Cowl Seal.



Kind Regards
Brendan Daly
Global Service Manager